

MC 45-A6 NOV. 1980
J. CARVER
M. HOLMES

(37)

WEBER, CACHE CO. LINE

SEE PAGE 34 BOOK MC-45 FOR
TRAVERSE

37° 38' 37" ALL

4° 21' 27.5"

BRASS CAP ME. 4x4 POST

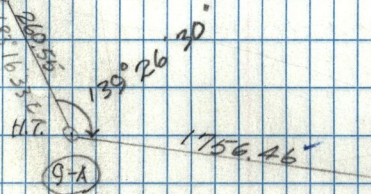

142° 21' 23"

H.T. (A)

